

## Quick Start

# Appearance

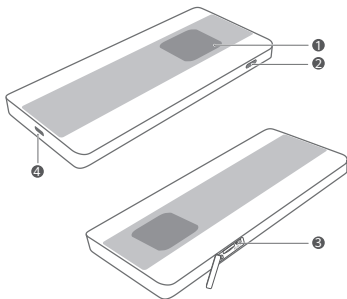

① AMOLED screen

② Power button

③ Reset button

④ USB Type-C port

# Inserting the SIM Card

Insert the SIM card into the slot with its chip side facing upwards, and the notched side facing inwards.

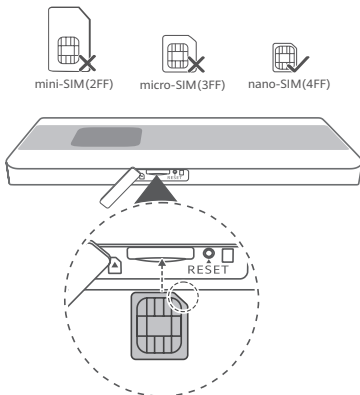

## Powering on the Mobile WiFi

Press and hold the Power button to power on the Mobile WiFi. Your Mobile WiFi searches for mobile network signals automatically after it is powered on.

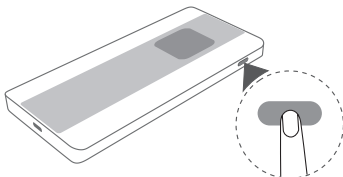

 Refer to the FAQs section below if your Mobile WiFi receives no signal or the signal reception is weak.

# On-screen gestures

Mobile WiFi features a touchscreen, which makes it easy to perform operations and check the device status.

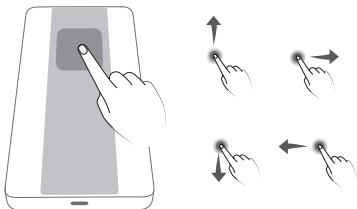

Swiping up	Swipe up on the home screen to display the more features screen.
Swiping down	Swipe down from the top of the home screen to display unread messages.
Swiping left/right	Swipe left or right from the middle of the screen to switch between screens.
	Swipe right from the left edge of the screen or swipe left from the right edge of the screen to return to the previous menu.

## Accessing the Internet

Connect your device to the Mobile WiFi to access the Internet. After powering on the Mobile WiFi, complete the startup wizard, then scan the QR code on the screen to connect to the Wi-Fi network. You can also touch the QR code to view the Wi-Fi name and password and manually connect to the Wi-Fi network.

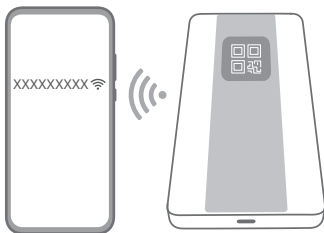

 Refer to the FAQs section below if you cannot access the Internet after you have connected to your Mobile WiFi.

## Device Management

You can manage the Mobile WiFi using the web-based management page. Swipe up on the home screen to find the default IP address and login password on the device information screen.



- If you cannot visit the web-based management page, check whether your mobile phone or computer is connected to your Mobile WiFi.
- We suggest that you modify the default Wi-Fi name and password, and the default login password to ensure that your data is secure.

## Charging

Charging your Mobile WiFi (super fast charging supported)

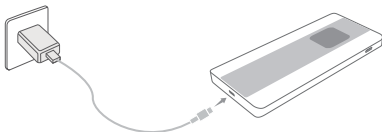

Please use the original charging cable and power adapter.

**i** The original charging cable can only be used for charging.

### Wired reverse charging for external devices

The USB Type-C port on the Mobile WiFi can be used for fast charging of external devices, such as mobile phones.

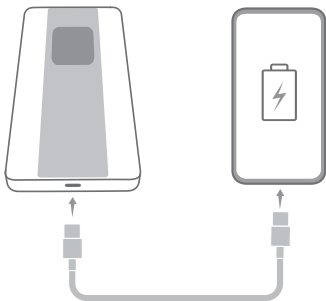



Charging capabilities of the USB Type-C port:

Charging the Mobile WiFi: 10 V/2.25 A (MAX)/9 V/2 A (MAX) for fast charging and 5 V/2 A for other charging modes.

Charging other devices: 9 V/2 A (MAX) for fast charging and 5 V/0.5 A for other charging modes.

Actual charging power may vary depending on usage and environmental factors.



- When the battery level is extremely low, or the device is overheating, reverse charging is automatically disabled.
- The USB-C to USB-C charging cable is an optional accessory. If it is not included in the package, you can purchase it separately from a retailer.

## FAQs

### **What should I do if my Mobile WiFi cannot receive any signal or cannot connect to the Internet?**

- Make sure that the SIM card is the right size and inserted correctly into the slot.
- Confirm that your SIM card has sufficient balance. If your SIM card is new, ensure that it has Internet access.
- Contact your carrier or SIM card dealer to check if any special configuration is required, such as for the APN.
- If the issue persists, restore your Mobile WiFi to its factory settings and try again.

### **What should I do if my Mobile WiFi's signal reception is weak or the Internet speed is slow?**

- Check whether the signal strength is strong on the AMOLED screen. If not, move the Mobile WiFi to a location near a window or to an open area for better signal reception, and make sure that you are not in an enclosed area.
- Check to confirm that you have not exceeded the monthly mobile data limit from your carrier.
- Check whether a large number of devices are connected to and using the Mobile WiFi's network. Or alternatively, the problem may be related to your use of the Mobile WiFi during peak traffic times, or when you are moving quickly.
- The Mobile WiFi features a built-in safeguard against overheating. If the temperature is too high, Internet speeds will be automatically limited to prevent the Mobile WiFi from overheating.
- Make sure that there are no physical barriers (such as cement walls) that may weaken the signal between the connected devices and Mobile WiFi.
- Turn off or move away from other 2.4 GHz wireless network devices, and other home electronics (such as microwave ovens) that may interfere with the Mobile WiFi's signal, and then try again.

### **What should I do if I can't connect to my Mobile WiFi after a period of inactivity?**

Your Mobile WiFi may be in sleep mode or powered off.

- Press the Power button on your Mobile WiFi. If the AMOLED screen turns on, it means that your Mobile WiFi was in sleep mode. In this mode, your Mobile WiFi automatically disables Wi-Fi to save power. You can disable sleep mode on the AMOLED screen or on the web-based management page.
- If there is no response after you press the Power button, your Mobile WiFi is powered off. Press and hold the Power button to power it back on.



Avoid using your Mobile WiFi where active wireless devices are prohibited (such as during flights), and ensure that it is powered off.

### **What should I do if reverse charging doesn't work?**

Connect the device to be charged to the Mobile WiFi using a charging cable to initiate charging. If the device doesn't charge, check whether the Mobile WiFi is powered on. If not, power on the Mobile WiFi and then try again. If the Mobile WiFi has been powered on, remove and re-insert the cable, and check whether the device is charging.

## Legal Notice

The product described in this manual may include copyrighted software of licensors. Customers shall not in any manner reproduce, distribute, modify, decompile, disassemble, decrypt, extract, reverse engineer, lease, assign, or sublicense the said software, unless such restrictions are prohibited by applicable laws or such actions are approved by respective copyright holders.

### Trademarks and Permissions

LTE is a trademark of ETSI.

Wi-Fi®, the Wi-Fi CERTIFIED logo, and the Wi-Fi logo are trademarks of Wi-Fi Alliance.

Other trademarks, product, service and company names mentioned may be the property of their respective owners.

### Notice

Some features of the product and its accessories described herein rely on the software installed, capacities and settings of local network, and therefore may not be activated or may be limited by local network operators or network service providers.

Thus, the descriptions herein may not exactly match the product or its accessories which you purchase.

We reserve the right to change or modify any information or specifications contained in this manual without prior notice and without any liability.

### DISCLAIMER

ALL CONTENTS OF THIS MANUAL ARE PROVIDED "AS IS". EXCEPT AS REQUIRED BY APPLICABLE LAWS, NO WARRANTIES OF ANY KIND, EITHER EXPRESS OR IMPLIED, INCLUDING BUT NOT LIMITED TO, THE IMPLIED WARRANTIES OF MERCHANTABILITY AND FITNESS FOR A PARTICULAR PURPOSE, ARE MADE IN RELATION TO THE ACCURACY, RELIABILITY OR CONTENTS OF THIS MANUAL.

TO THE MAXIMUM EXTENT PERMITTED BY APPLICABLE LAWS, IN NO EVENT SHALL ZOWEE BE LIABLE FOR ANY SPECIAL, INCIDENTAL, INDIRECT, OR CONSEQUENTIAL DAMAGES, OR LOSS OF PROFITS, BUSINESS, REVENUE, DATA, GOODWILL SAVINGS OR ANTICIPATED SAVINGS REGARDLESS OF WHETHER SUCH LOSSES ARE FORESEEABLE OR NOT.

THE MAXIMUM LIABILITY (THIS LIMITATION SHALL NOT APPLY TO LIABILITY FOR PERSONAL INJURY TO THE EXTENT APPLICABLE LAW PROHIBITS SUCH A LIMITATION) OF ZOWEE ARISING FROM THE USE OF THE PRODUCT DESCRIBED IN THIS MANUAL SHALL BE LIMITED TO THE AMOUNT PAID BY CUSTOMERS FOR THE PURCHASE OF THIS PRODUCT.

## **Import and Export Regulations**

Customers shall comply with all applicable export or import laws and regulations and be responsible to obtain all necessary governmental permits and licenses in order to export, re-export or import the product mentioned in this manual including the software and technical data therein.

## **Privacy Policy**

To learn how we use and protect your personal information on this device, please access the web-based management page, and read the Privacy Statement for Mobile Broadband Devices to learn about our privacy policy.

## **Software Update**

By continuing to use this device, you indicate that you have read and agree to the following content:

In order to provide better service, this device will automatically obtain software update information from ZOWEE or your carrier after connecting to the Internet. This process will use mobile data, and require access to your device's unique identifier (SN) and the service provider network ID (PLMN) to check whether your device needs to be updated.

This device supports the automatic update feature. Once enabled, the device will automatically download and install critical updates from ZOWEE or your carrier. This feature is enabled by default, and can be configured from the settings menu on the web-based management page.

# Safety information



[Warning] Please read all of the safety information carefully before using your device to ensure its safe and proper operation and to learn how to dispose of your device properly.

## Electronic device

Do not use your device if using the device is prohibited. Do not use the device if doing so causes danger or interference with other electronic devices.

## Interference with medical equipment

- Follow rules and regulations set forth by hospitals and health care facilities. Do not use your device where prohibited.
- Some wireless devices may affect the performance of hearing aids or pacemakers. Consult your service provider for more information.
- Pacemaker manufacturers recommend that a minimum distance of 15 cm be maintained between a device and a pacemaker to prevent potential interference with the pacemaker. If using a pacemaker, hold the device on the side opposite the pacemaker and do not carry the device in your front pocket.
- Please consult your doctor and the device manufacturer to determine if using your device may interfere with the operation of your medical device.

## Areas with flammables and explosives

- Do not use the device where flammables or explosives are stored (in a gas station, oil depot, or chemical plant, for example). Using your device in these environments increases the risk of explosion or fire. In addition, follow the instructions indicated in text or symbols.
- Do not store or transport the device in containers with flammable liquids, gases, or explosives.

## Traffic security

- Observe local laws and regulations while using the device. To reduce the risk of accidents, do not use your wireless device while driving.
- Concentrate on driving. Your first responsibility is to drive safely.
- RF signals may affect the electronic systems of motor vehicles. For more information, consult the vehicle manufacturer.
- Do not place the device over the air bag or in the air bag deployment area in a motor vehicle. Doing so may hurt you because of the strong force when the air bag inflates.
- Wireless devices may interfere with the airplane's flight system. Do not use your device where wireless devices are not allowed according to the airplane company's regulations.

## **Operating environment**

- Avoid dusty, damp, or dirty environments. Avoid magnetic fields. Using the device in these environments may result in circuit malfunctions.
- Do not use your device during thunderstorms to protect your device against any danger caused by lightning.
- Ideal operating temperatures are 0 °C to 35 °C. Ideal storage temperatures are -20 °C to +45 °C. Extreme heat or cold may damage your device or accessories.
- Keep the device and accessories in a well-ventilated and cool area away from direct sunlight. Do not enclose or cover your device with towels or other objects. Do not place the device in a container with poor heat dissipation, such as a box or bag.
- Do not expose your device to direct sunlight (such as on a car dashboard) for prolonged periods.
- To protect your device or accessories from fire or electrical shock hazards, avoid rain and moisture.
- Keep the device away from sources of heat and fire, such as a heater, microwave oven, stove, water heater, radiator, or candle.
- Stop using your device or applications for a while if the device is overheated. If skin is exposed to an overheated device for an extended period, low temperature burn symptoms, such as red spots and darker pigmentation, may occur.
- Do not touch the device's antenna. Otherwise, communication quality may be reduced.
- Do not allow children or pets to bite or suck the device or accessories. Doing so may result in damage or explosion.
- Observe local laws and regulations, and respect the privacy and legal rights of others.

## **Child safety**

- Comply with all precautions with regard to child safety. Letting children play with the device or its accessories may be dangerous. The device includes detachable parts that may present a choking hazard. Keep away from children.
- The device and its accessories are not intended for use by children. Children should only use the device with adult supervision.

## **Accessories**

- Using an unapproved or incompatible power adapter, charger or battery may cause fire, explosion or other hazards.
- Choose only accessories approved for use with this model by the device manufacturer. The use of any other types of accessories may void the warranty, may violate local regulations and laws, and may be dangerous. Please contact your retailer for information about the availability of approved accessories in your area.

## **Charger safety**

- For pluggable devices, the socket-outlet shall be installed near the devices and shall be easily accessible.
- Unplug the charger from electrical outlets and the device when not in use.
- Do not drop or cause an impact to the charger.
- If the power cable is damaged (for example, the cord is exposed or broken), or the plug loosens, stop using it at once. Continued use may lead to electric shocks, short circuits, or fire.
- Do not touch the device or the charger with wet hands. Doing so may lead to short circuits, malfunctions, or electric shocks.
- Ensure that the power adapter meets the requirements of IEC/EN 62368-1 and has been tested and approved according to national or local standards.
- Connect the device only to products with the USB-IF logo or with USB-IF compliance program completion.

## **Battery safety**

- Do not connect battery poles with conductors, such as keys, jewelry, or other metal materials. Doing so may short-circuit the battery and cause injuries or burns.
- Keep the battery away from fire, excessive heat, extremely low air pressure and direct sunlight. Do not place it on or in heating devices. Do not disassemble, modify, throw, or squeeze it. Do not insert foreign objects into it, submerge it in liquids, or expose it to external force or pressure, as this may cause it to leak, overheat, catch fire, or even explode.
- Do not attempt to modify or remanufacture the battery, insert foreign objects into it, or immerse or expose it to water or other liquids. Doing so may lead to fire, explosion, or other hazards.
- If the battery leaks, ensure that the electrolyte does not make direct contact with your skins or eyes. If the electrolyte touches your skins or splashes into your eyes, immediately flush with clean water and consult a doctor.
- Do not put batteries in fire as they may explode. Damaged batteries may also explode.
- Dispose of used batteries in accordance with local regulations. Improper battery use may lead to fire, explosion, or other hazards.
- Do not allow children or pets to bite or suck the battery. Doing so may result in damage or explosion.
- Do not smash or pierce the battery, or expose it to high external pressure. Doing so may lead to a short circuit or overheating.
- Do not drop the device or battery. If the device or battery is dropped, especially on a hard surface, it may be damaged.
- When the device has a built-in, non-removable battery, do not attempt to remove the battery, otherwise the device may be damaged.



## Cleaning and maintenance

- Keep the device and accessories dry. Do not attempt to dry it with an external heat source, such as a microwave oven or hair dryer.
- Do not expose your device or accessories to extreme heat or cold. These environments may interfere with proper function and may lead to fire or explosion.
- Avoid collision, which may lead to device malfunctions, overheating, fire, or explosion.
- Before you clean or maintain the device, stop using it, stop all applications, and disconnect all cables connected to it.
- Do not use any chemical detergent, powder, or other chemical agents (such as alcohol and benzene) to clean the device or accessories. These substances may cause damage to parts or present a fire hazard. Use a clean, soft, and dry cloth to clean the device and accessories.
- Do not place magnetic stripe cards, such as credit cards and phone cards, near the device for extended periods of time. Otherwise the magnetic stripe cards may be damaged.
- Do not dismantle or remanufacture the device and its accessories. This voids the warranty and releases the manufacturer from liability for damage.

## Disposal and recycling information



The symbol on the product, battery, literature, or packaging means that the products and batteries should be taken to separate waste collection points designated by local authorities at the end of the lifespan. This will ensure that EEE waste is recycled and treated in a manner that conserves valuable materials and protects human health and the environment.

For more information, please contact your local authorities, retailer, or household waste disposal service or visit the website <https://www.brovi-tech.com>.

## Reduction of hazardous substances

This device and its electrical accessories comply with local applicable rules on the restriction of the use of certain hazardous substances in electrical and electronic equipment, such as EU REACH regulation, RoHS and Batteries (where included) directive. For declarations of conformity about REACH and RoHS, please visit the website <https://www.brovi-tech.com>.

## **RF Exposure Information**

For the countries that adopt the SAR limit of 2.0 W/kg over 10 grams of tissue. The device complies with RF specifications when used at a distance of 0.5 cm from your body. The highest reported SAR value: body SAR: 1.217 W/kg.

## **EU regulatory conformance**

Hereby, ZOWEE TECHNOLOGY (HEYUAN) CO., LTD. declares that this device E6888-982 is in compliance with the following Directive: RED 2014/53/EU, RoHS 2011/65/EU, ErP 2009/125/EC.

The full text of the EU declaration of conformity, the detailed ErP information and most recent information about accessories & software are available at the following internet address:

<https://www.brovi-tech.com>.

Press and hold the Power button to power on/off the Mobile WiFi. (Both cellular and Wi-Fi networks will be turned on/off.)

### **Restrictions in the 5 GHz band:**

The 5150 to 5350 MHz frequency range is restricted to indoor use in: AT, BE, BG, CH, CY, CZ, DE, DK, EE, EL, ES, FI, FR, HR, HU, IE, IS, IT, LI, LT, LU, LV, MT, NL, NO, PL, PT, RO, SE, SI, SK, TR, UK(NI).

In accordance with the relevant statutory requirements in the UK, the 5150 to 5350 MHz frequency range is restricted to indoor use in the United Kingdom.

## **Frequency Bands and Power**

Frequency bands in which the radio equipment operates: Some bands may not be available in all countries or all areas. Please contact the local carrier for more details.

LTE Band 1/3/7/8/20/28/38/40/42/43: 25dBm, 5G NR SA Band n3/n8/n20/n28/n38/n80/n81/n82/n83/n84: 25.7dBm, 5G NR SA Band n40/n41/n77/n78: 29dBm, 5G NR SA Band n1/n7: 26dBm, 5G NR NSA Band n3/n8/n20/n28/n38: 25.7dBm, 5G NR NSA Band n41/n78: 29dBm, 5G NR NSA Band n1/n7/n40/n77: 26dBm, Wi-Fi 2.4GHz: 20dBm, Wi-Fi 5GHz: 5150-5250MHz: 23dBm, 5250-5350MHz: 23dBm, 5470-5725MHz: 30dBm.